

Design Process

5. second pin-up

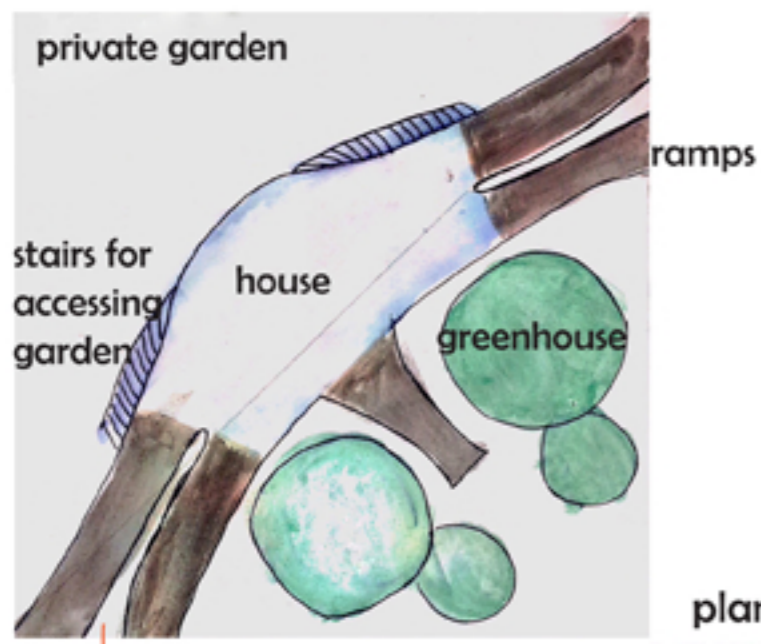

We want to hide the digesters from outside as well as combine the digesters with the design of our residential house.
So mainly we have two tasks:
1. We should cover the biogas digesters
2. When we combine the digesters with the house, we should make sure the bad smell wouldn't go into the house

plan (1:500)

2 holes in both sides of the ramps for making nature ventilation

we use geodesic dome technique for making greenhouse

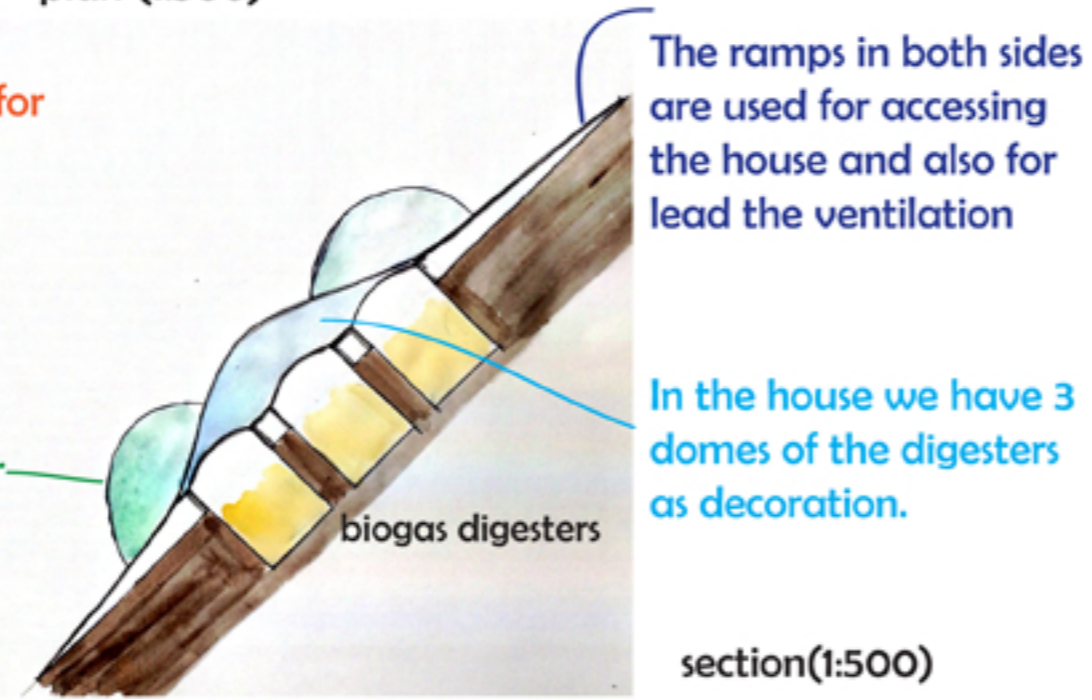

section(1:500)

The ramps in both sides are used for accessing the house and also for lead the ventilation

In the house we have 3 domes of the digesters as decoration.

MODEL

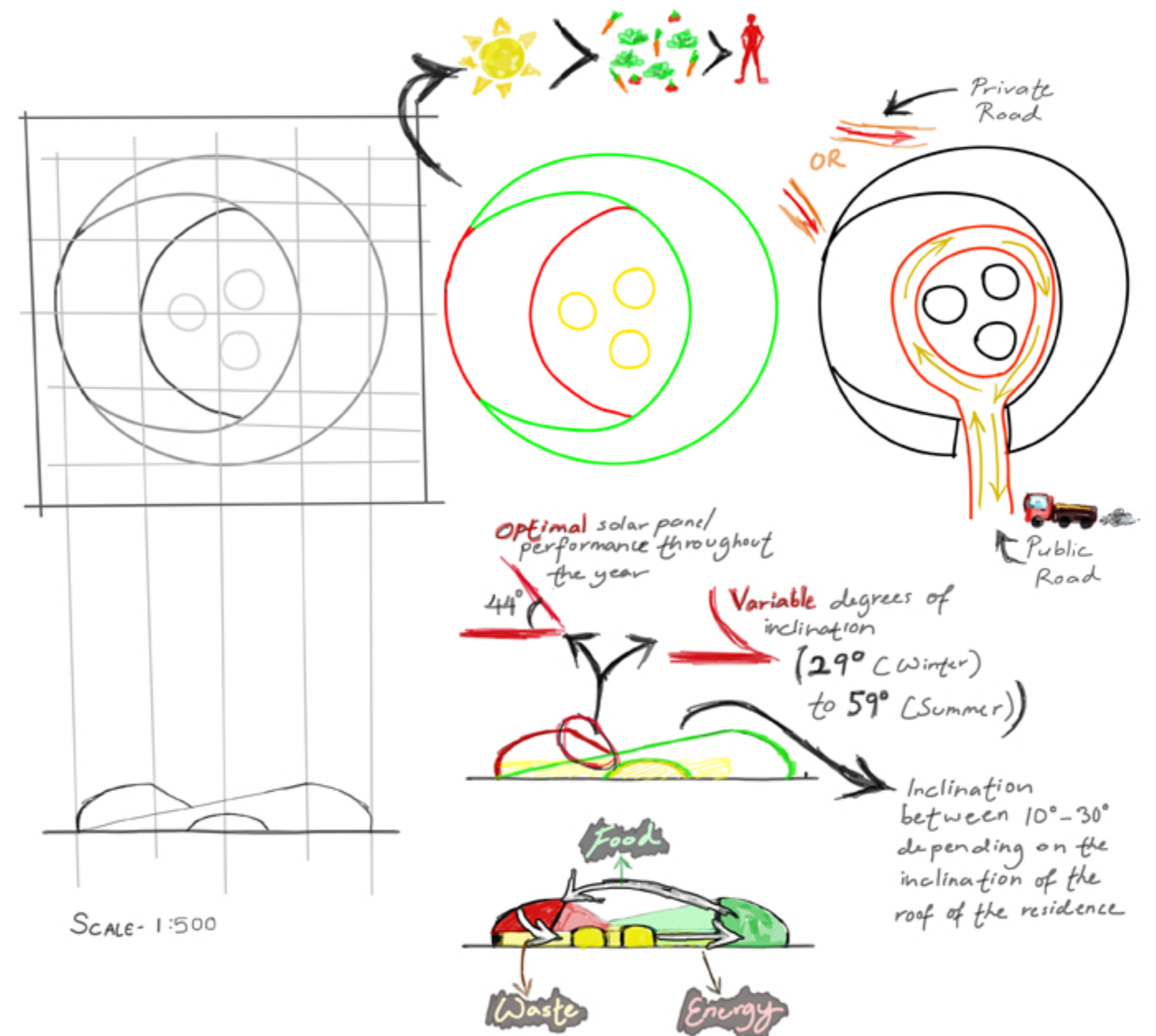
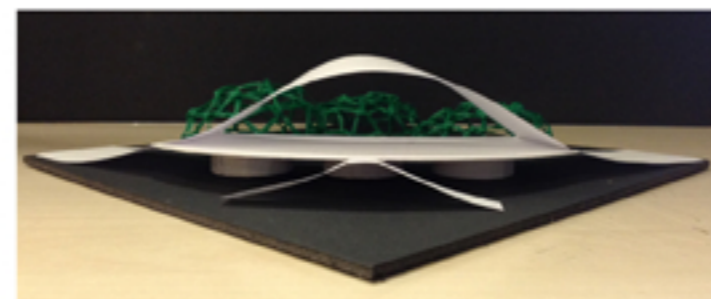
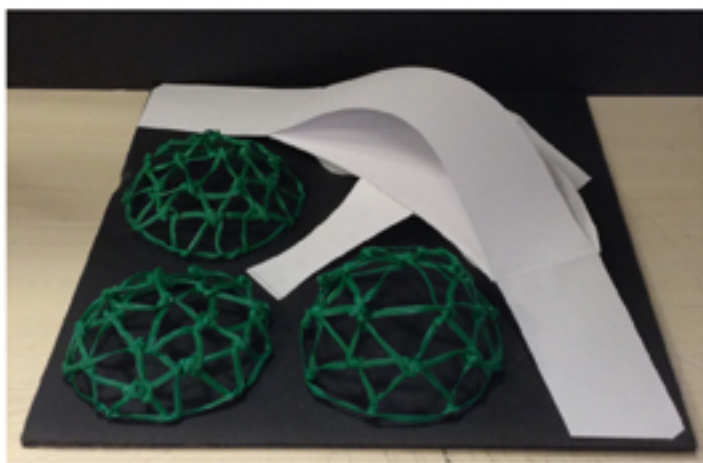

Scale- 1:500

DIGITAL MODEL

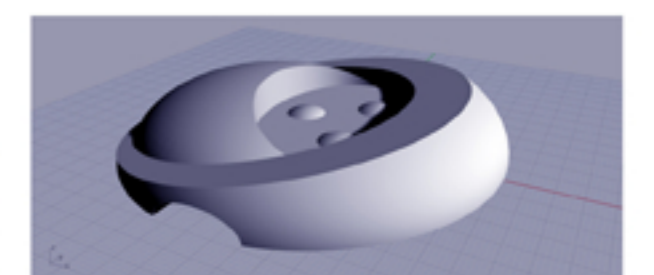
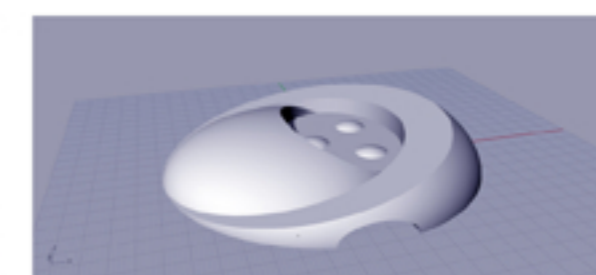
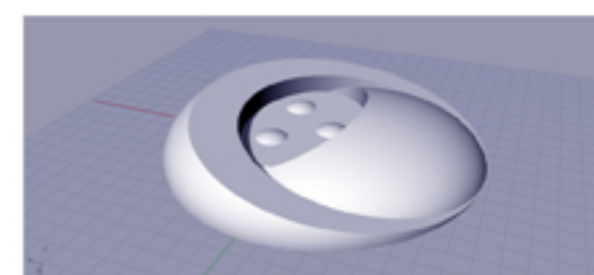

6. Midterm pin-up

